

General Measuring Guidelines – All Pool Shapes

Measuring your pool will be easier if you have another person helping you. Also, draining your pool will make the measuring process easier, however, it is not necessary. Measurements can be easily taken from outside of the pool.

Never assume your pool is standard. All pools are different. Please measure your pool for an exact fit. Actual pool measurements should be made even if original pool plans are available due to the fact that slight variances may have occurred during construction. The builder may not have followed the pool plan precisely.

When measuring the pool, do not make allowances for weather conditions, temperature, or the fact that vinyl shrinks and expands. These calculations are made when the new liner is designed.

Please supply all measurements in feet and inches. Round your measurements up to the nearest whole inch.

Follow the “step by step” instructions carefully, referring to all diagrams to ensure accurate measurements.

Remember to include your name, address, phone and fax numbers on each page that you send to us. You must also sign the MEASURING FORM before we can begin designing your liner.

Remember to record ALL of your measurements on the MEASURING form. You may need to transfer measurements you have made on the “Measuring Instructions” pages onto the actual MEASURING FORM.

Write your measurements legibly, using BLACK INK. (No pencil or felt-tip marker please!) Make copies of all pages for your records BEFORE sending them to us. You will need to refer to your copies if we have questions regarding your measurements.

Don't forget! If you're stuck you can contact us at:

Email: support@ezpoollinerdirect.com

On-line: EZPoolLinerDirect.com

NOTE:

If you have already ordered your In Ground liner on-line we will already have your contact and shipping information. You will also have specified your shape, width, length, pattern and gauge when getting your on-line pricing.

Please enter this information, as well as your Order reference on the Measuring form for verification. You will have this on your order confirmation email from us.

MEASURING INSTRUCTIONS Step-by-Step

Oval Pools

Step #1: Determine your liner type.

If you have a Beaded liner, select "Beaded" on the Measuring Form. If you have an Overlap liner, please also indicate the amount of overlap in inches.

Step #2: Measure the Width (A) and the Length (B)

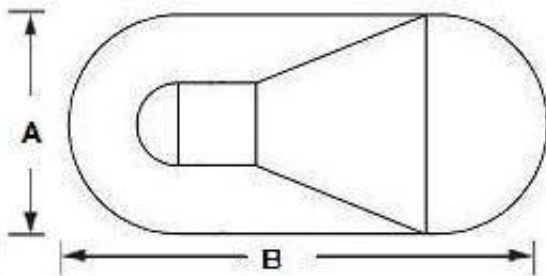

Referring to the illustration of your oval pool, be sure that the width (A) and the length (B) measurements are made at the bead receiver (where the liner snaps into the track), not at the edge of the coping (the edge of the pool deck).

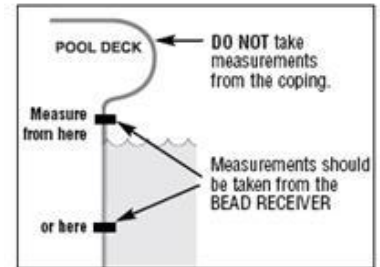

Record all measurements in the MEASURING FORM.

Step #3: Measure Diagonals

For an OVAL pool, you will need to measure the pool on the diagonals (#1 and #2). Refer to the diagram to locate the diagonals. Remember to use the bead receiver (pool edge) as the reference point.

The diagonals are often overlooked, but they are important because few pools are perfectly square. There can be a substantial difference end-to-end in a pool, and that needs to be noted if a liner is to fit properly. (The Computer Aided Design System that engineers your liner can adjust for out of square pools.)

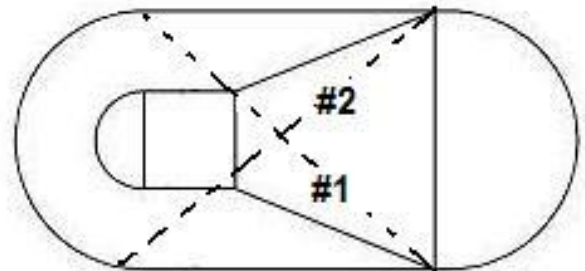

Measure the diagonals from the where the oval ends meet the straight sides of the wall. Note that this might not be where the shallow end starts.

Record all measurements in the MEASURING FORM.

Step #4: Measuring Shallow End Covered Bottoms

Refer to the diagram below to determine if you have a Shallow End Covered Bottom. If you have a Shallow End Covered Bottom, follow these easy steps to take measurements (J), (J1), (J2) and (G1).

If you do not have a Shallow End Covered Bottom, proceed to the next step.

STEP 4.1: Measure the depth (J) of the shallow end of your pool. Be sure to measure from the bottom of the pool floor to the bead receiver (for beaded liners) OR to the board where the liner is nailed/stapled (for overlap liners). DO NOT measure to the top of the pool if you have a beaded liner, your measurement will be incorrect.

STEP 4.2: Measure from the bead track (beaded hung liners) or from top of the pool (overlap hung liners) down to where the cove (J1) begins. Subtract (J1) from (J) to determine (J2).

STEP 4.3: With a pole, locate the spot where the cove meets the floor. Use a carpenter's level to verify that the pole is vertical. Measure from the pool wall to the pole to determine (G1).

STEP 4.4: If the cove along the sidewall differs from the end wall cove, please notate on separate paper and include with the measuring form.

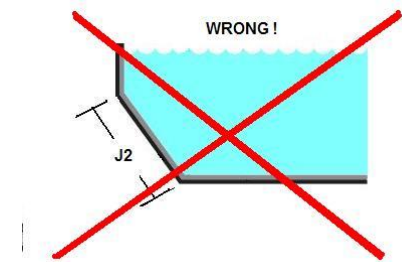
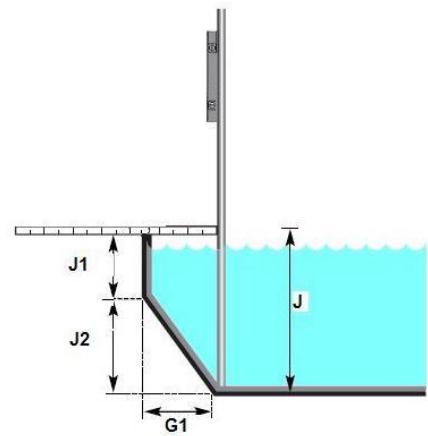

BE SURE THAT (J2) IS A HORIZONTAL MEASUREMENT, DO NOT MEASURE THE SLOPE OF THE COVE. We only use measurements parallel to the deck.

Step #5: Horizontal Measurements of Pool Bottom and Depth Measurements

Choose the Bottom Contour of your pool from the illustration below to determine which measurements you will need to take. You will also specify this on the MEASURING FORM.

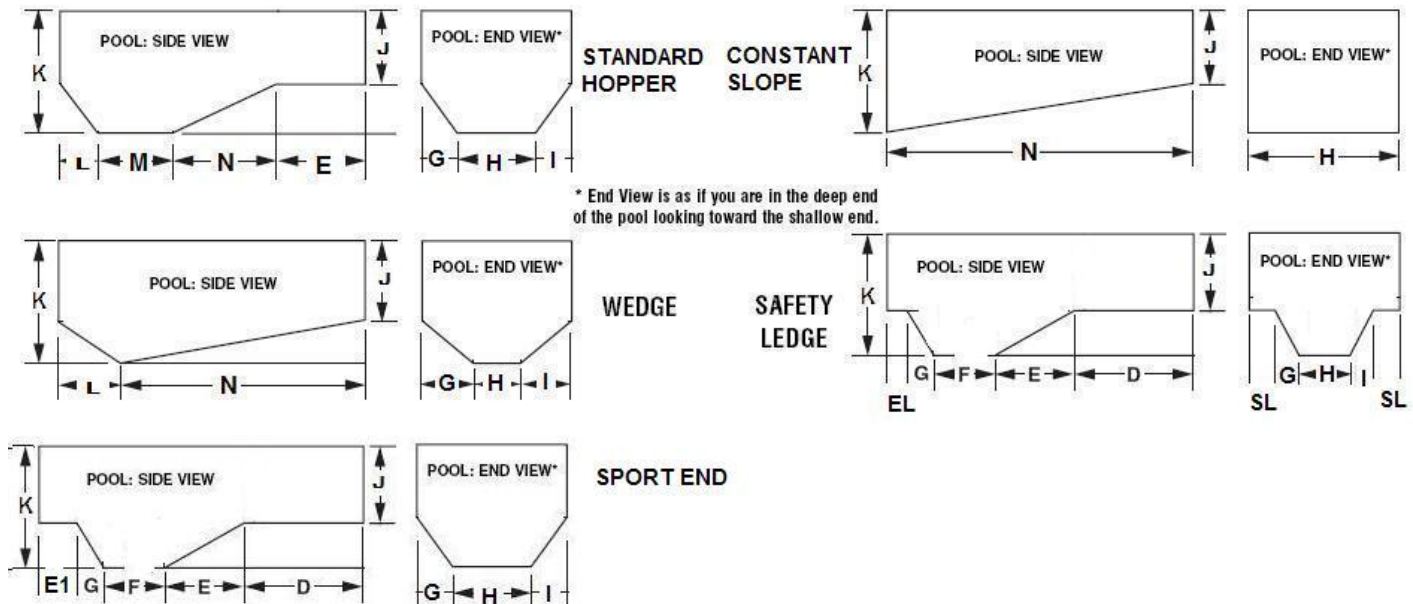

NOW DO I MEASURE THE BOTTOM OF MY POOL?

You will be able to make horizontal measurements of your pool bottom without entering the pool. Taking these measurements is easier than you may think, when you use this easy-to-make measuring tool.

YOU WILL NEED THE FOLLOWING ITEMS:

1. A long straight pole (telepole)
2. String attached to one end of the pole
3. Some sort of weight tied to the other end of the string
4. A measuring tape

Follow the instructions below, using your fishing pole, to make these measurements.

Horizontal Bottom Measurements: Use your "fishing pole" to "fish" for a point on the bottom of the pool. With the pole parallel to the ends of the pool and the string vertical (allow no slack in the string), measure the distance from the edge of the pool (water's edge) to the end of the pole where string is attached. You should "fish" for points that will achieve the desired measurements based on the bottom contour of your pool.

For example, to take measurement (G) or (I), you would stand on one side of the pool, and "fish" for a corner of the Hopper. You would then measure the distance from the edge of the pool (water's edge) to the end of the pole where the string is attached.

Depth Measurements: When taking the depth measurements (J) and (K), be sure to measure from the bottom of the pool floor to the bead receiver (for beaded liners) OR to the top board where the liner is nailed or stapled (for overlap liners). Do not measure to the top of the pool if you have a bead receiver, your measurement will be incorrect.

ARE YOU MEASURING THE BOTTOM OF YOUR POOL CORRECTLY?

Be sure you are NOT measuring the slopes when taking horizontal bottom measurements. We only use measurements parallel to the deck. See the diagram at right for the correct way to measure a coved bottom. Select the bottom contour of your pool as illustrated previously.

Quick Check Of Your Measurements

L+M+N+E must equal B for a Standard Hopper

(B is the length of pool taken in Step #2)

L+N must equal B for a Wedge

(B is the length of pool taken in Step #2)

E1+L+M+N+E must equal A for a Sport End

(A is the length of pool taken in Step #2)

L+M+N+E +EL must equal A for a Safety Ledge

(A is the length of pool taken in Step #2)

G+H+I must equal A for Standard Hopper and Wedge

(A is the width of pool taken in Step #2)

SL+G + H + I + H + SL must equal A for Safety Ledge

(A is the width of pool taken in Step #2)

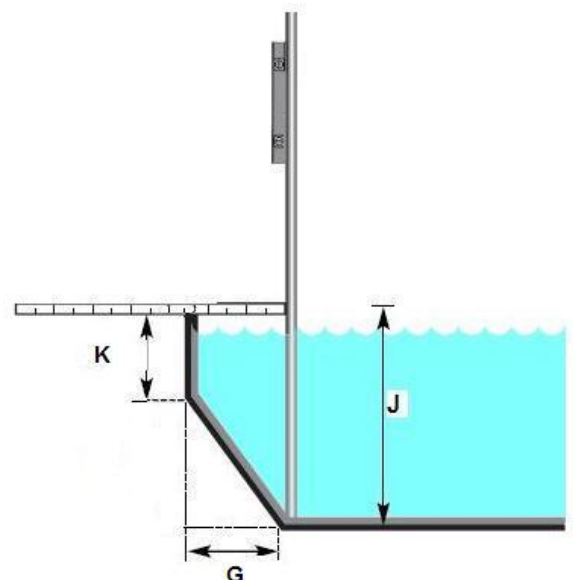

Make sure that you are taking measurements of the pool bottom on a horizontal plane. **If you measure the slopes of the pool, you will have an incorrect measurement.**

The measurements you take will depend on what style of bottom contour your pool has.

Record all measurements in the MEASURING FORM.

Step #5: Vinyl-Covered Step Sections

If your pool has a built-in step section that is covered with vinyl, you must complete the Vinyl Covered Step Section of the MEASURING FORM.

Last Step: Relax! Sit back and wait for your In Ground liner from **EZ PoolLinerDirect**. We'll send you an email confirming your measurements have been verified and that your order has been processed. At that time we will notify you of the expected shipment date.

OVAL Pool Inground Liner Measuring Form

Name: _____
Address: _____
City: _____ **State/Prov:** _____ **Zip/Postal Code:** _____
Phone: Home (____) _____ Work (____) _____
Fax: (____) _____ **Email** _____

Liner Type

Beaded

Overlap How much overlap? _____ in.

Bottom Contour Type

Pattern: _____

Gauge: _____

Dimensions

Width (A) _____ ft _____ in

Length (B) _____ ft _____ in

Diag#1 _____ ft _____ in

Diag#2 _____ ft _____ in

Wall Height (J) _____ ft _____ in

Depth (K) _____ ft _____ in

Shallow (E) _____ ft _____ in

Transition (N) _____ ft _____ in

Hopper Length (M) _____ ft _____ in

Up Slope (L) _____ ft _____ in

Sport End (E1) _____ ft _____ in

Left Side (G) _____ ft _____ in

Hopper Width (H) _____ ft _____ in

Right Side (I) _____ ft _____ in

Safety Ledge (if applicable)

Side (SL) _____ ft _____ in

End (EL) _____ ft _____ in

Shallow Cove (if applicable)

J1 _____ ft _____ in

J2 _____ ft _____ in

G1 _____ ft _____ in

Note: If your pool bottom contour determines what dimensions must be specified.

Vinyl Covered Step Section
 (Please fill out the Step Section Measuring Form)

Comments

Order No.	Signature
_____	_____

Your signature indicates that you have verified your measurements and that the information you have provided is correct. Your new vinyl liner will be made to these specifications.